

KEYPLAN

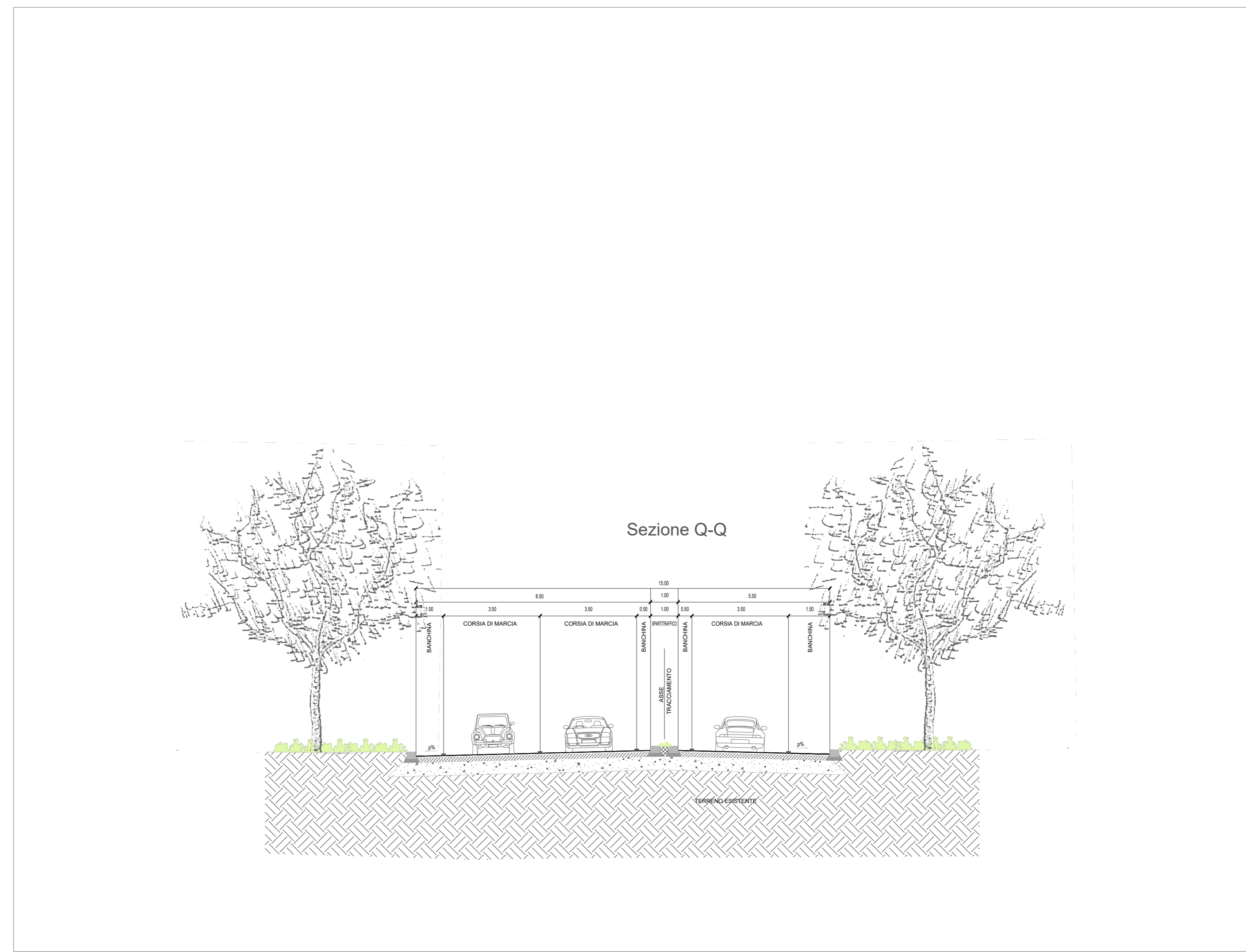
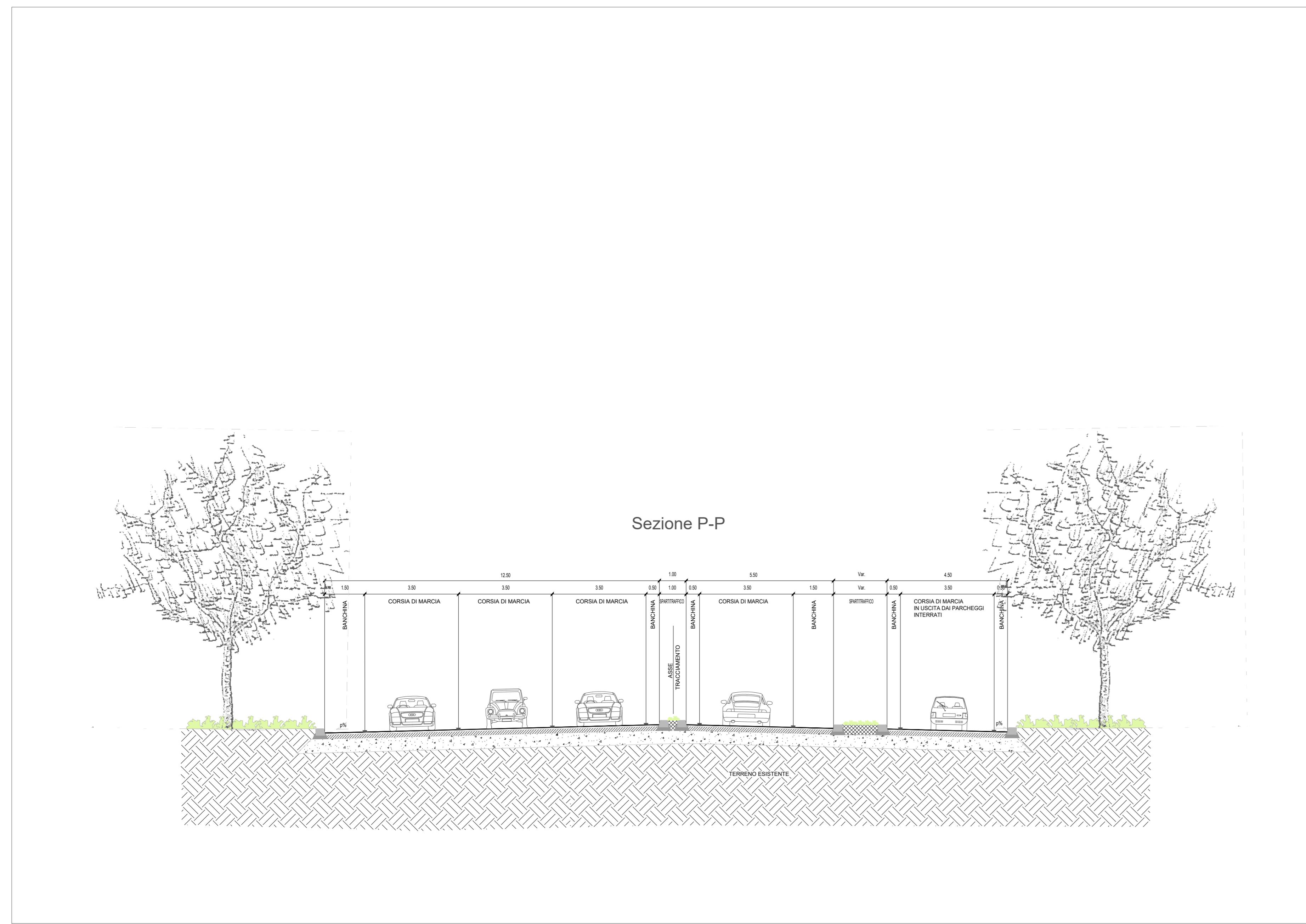
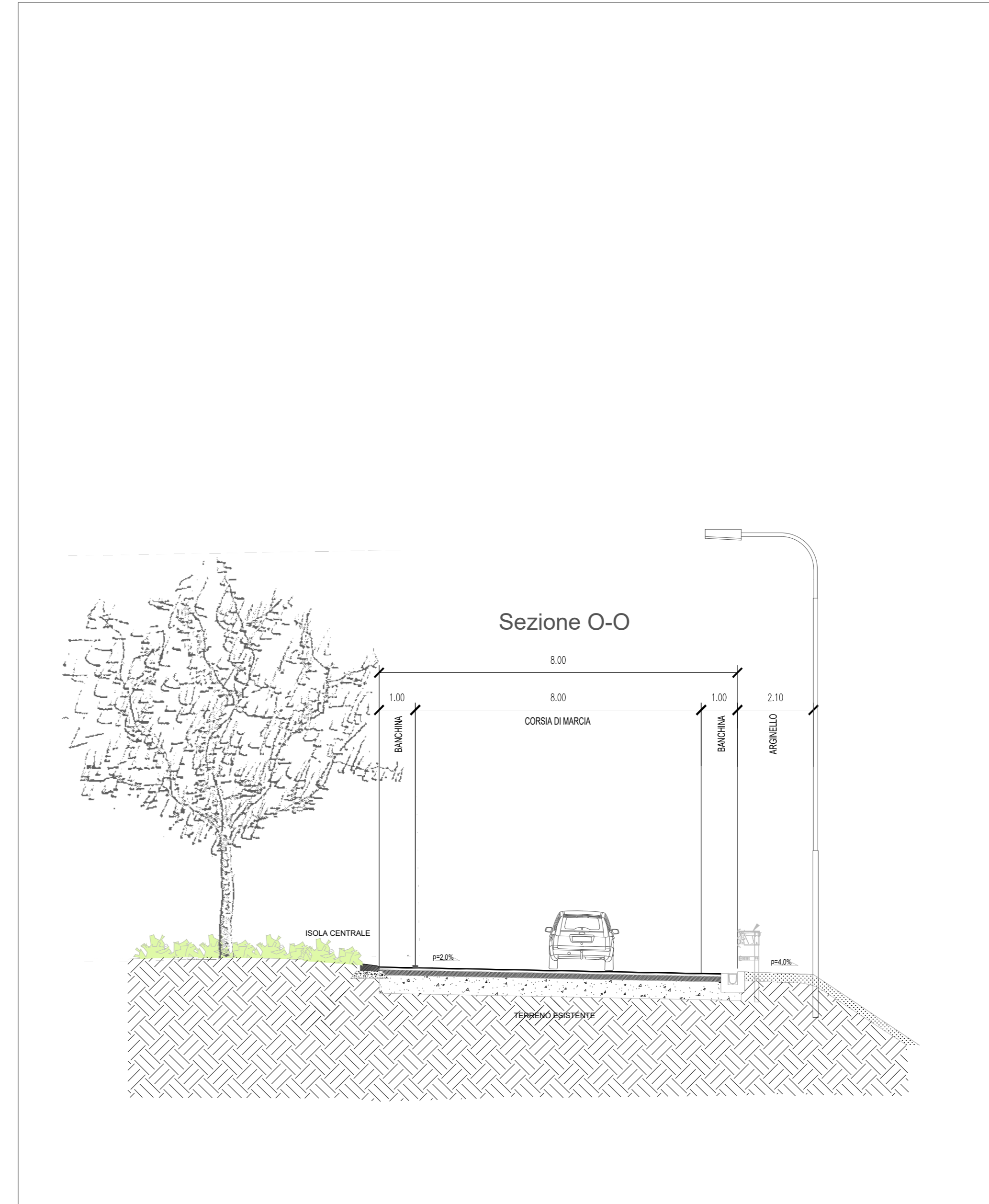
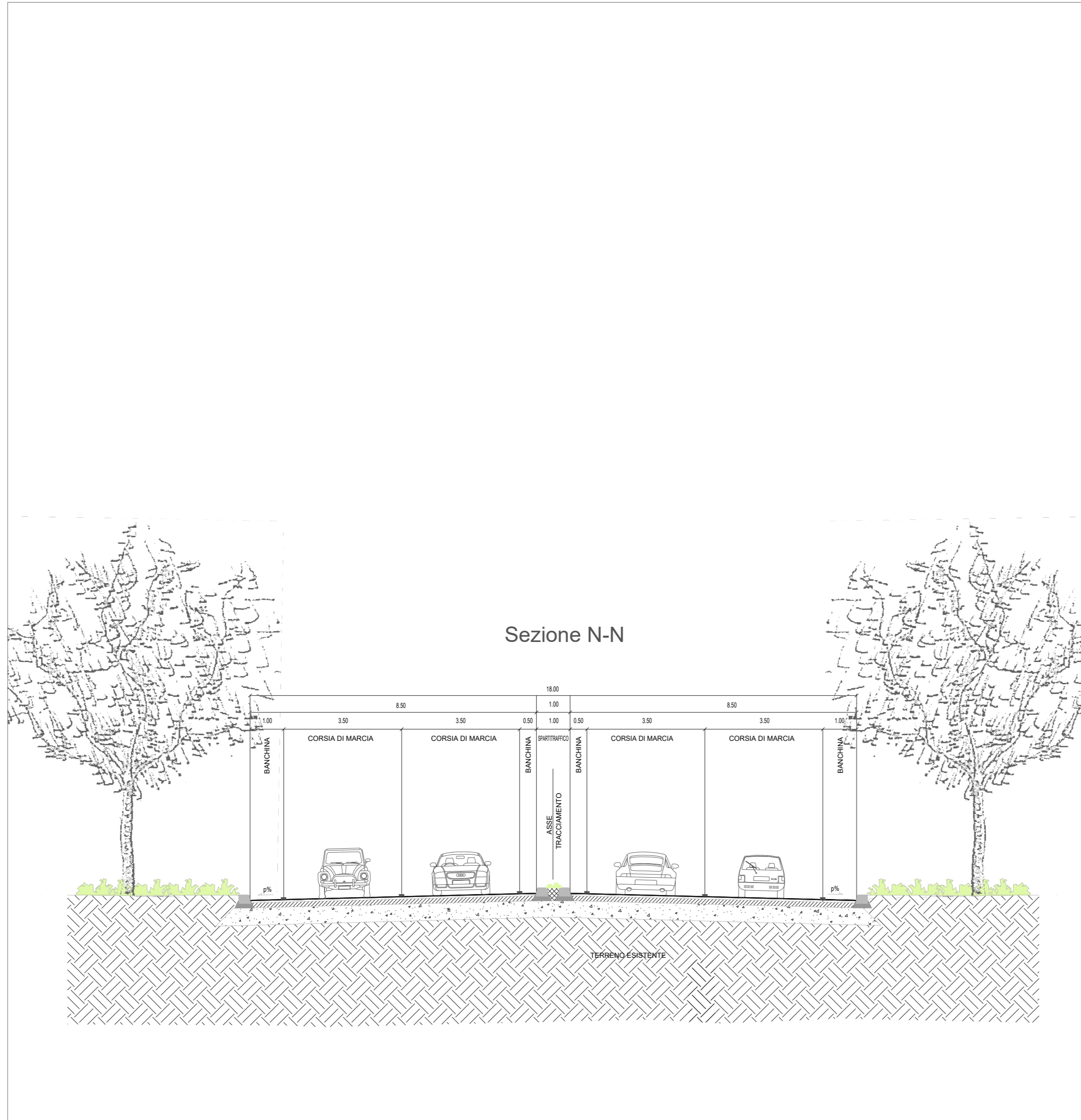
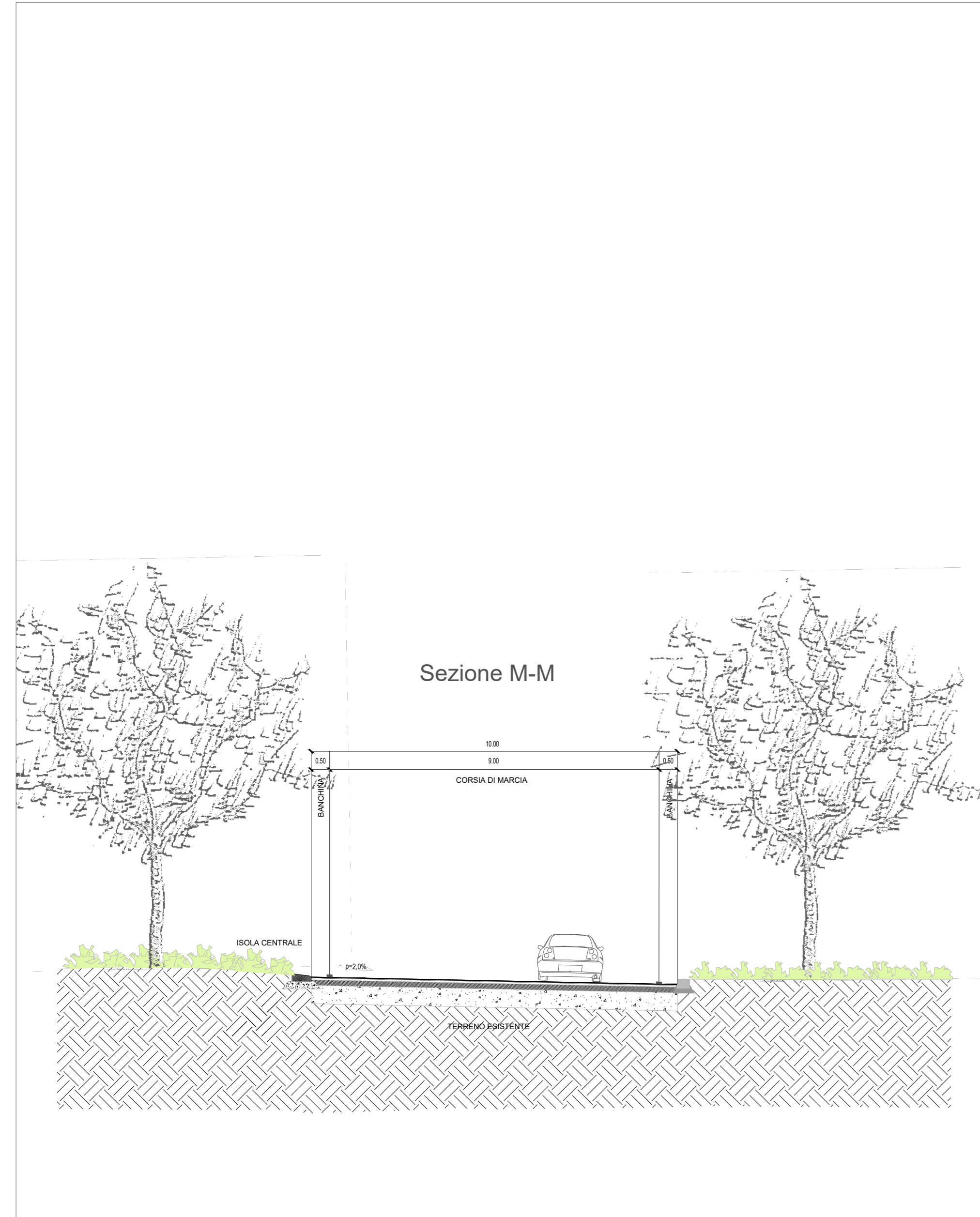
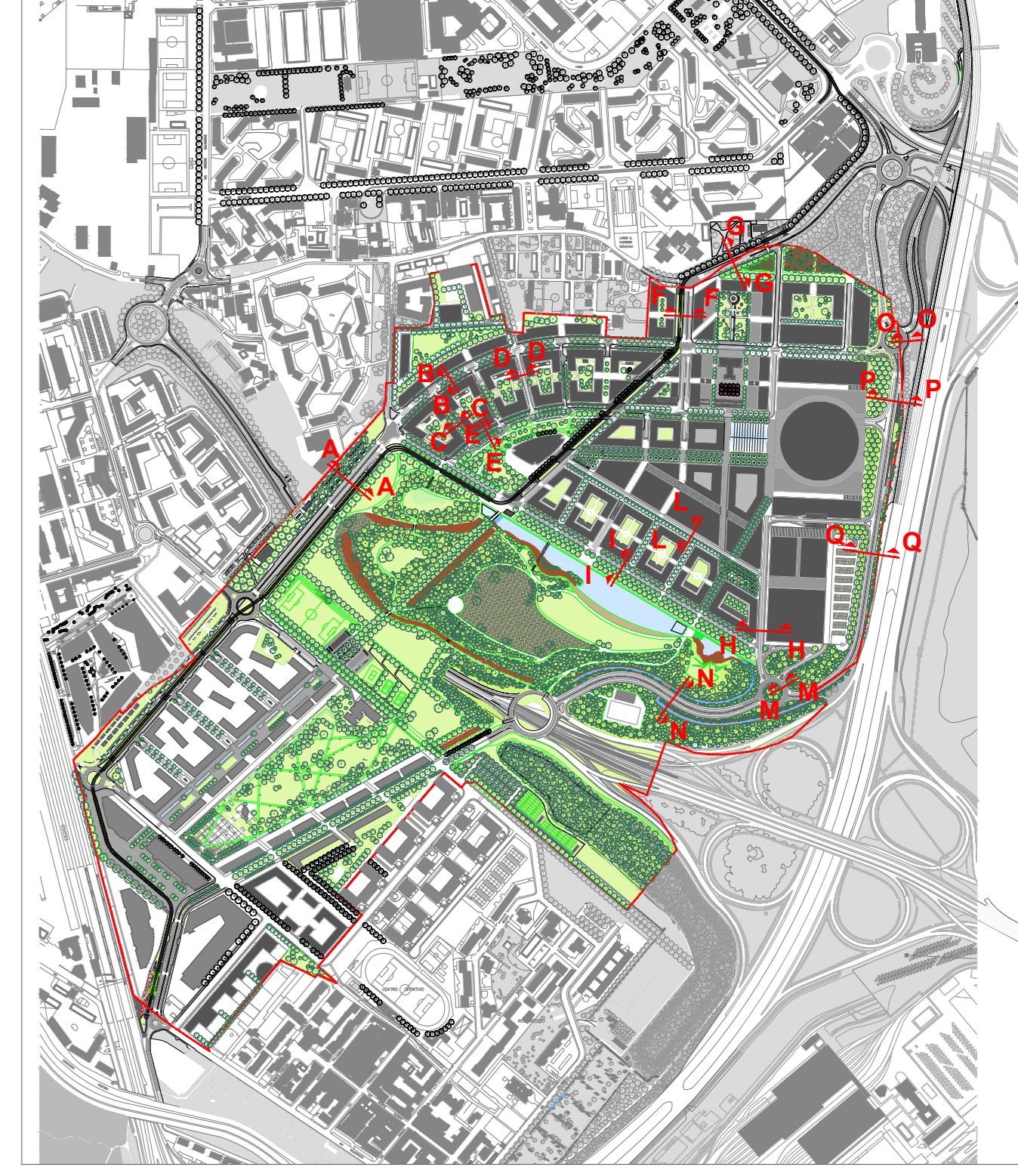

Team di progettazione  
**Foster + Partners**

Architexna Engineering  
 Belvedere Inzaghi & Partners  
 GAE Engineering  
 Jones Lang Lasalle  
 J+S  
 Makno  
 Manens-Tifs

Milan Ingegneria  
 Museo della Scienza e della  
 Tecnologia Leonardo da Vinci  
 Sigest  
 Studio Architettura Urbanistica  
 Paolo Pomodoro  
 Studio Tecnico Emanuele Morelli  
 Systematica

Proprietà  
**Milano Santa Giulia S.p.A.**  
**Esselunga S.p.A.**

**Comune di Milano**  
**Pil Montecity - Rogoredo**  
**Proposta definitiva**  
**di variante**

Progettista  
 Sezioni tipologiche Tav. 3 di 3

Scala	data	disegnatore	numerazione	num. provenienza	revisione
1:100	Aprile 2020	J+S	PR42C	A-000	01